

# MOTORI PER ASPIRAPOLVERE

## MOTORS FOR VACUUM-CLEANERS

### CARATTERISTICHE TECNICHE:

Esecuzione con due cuscinetti a sfere.  
 Due impedenze antidisturbo radio.  
 Classe d'isolamento B Grado II.  
 Motore monofase 230V 50/60 Hz.  
 Costruzione conforme alle norme CE.

### TECHNICAL CHARACTERISTICS:

Execution with two ball bearings.  
 Two radio antijamming impedances.  
 Insulation class B Degree II.  
 230V 50/60 Hz single-phase motor.  
 CE norms.

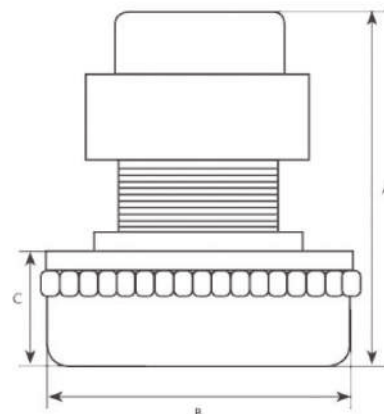

Articolo Art.	Potenza max W Max power W	A	Ø B	C	Stadi Stages
ASP. 312	1100	131	144	40	1



Articolo Art.	Potenza max W Max power W	A	Ø B	C	Stadi Stages
ASP. 309	800	157	144	66.5	2
ASP. 311	900	165	144	66.5	2



**NOVITÀ**  
NEW

Articolo Art.	Potenza max W Max power W	A	Ø B	C	Stadi Stages
ASP. 313	1300	190	144	92	3



Articolo Art.	Potenza max W Max power W	A	Ø B	C	Stadi Stages
ASP. 308	1000	156	144	66.5	2
ASP. 310	1300	162	144	66.5	2