

# PULSANTIERE A FUNGO

## CONTROL STATIONS WITH MUSHROOM



PF. 10



PF.20



**Pulsantiere a fungo assiale instabile Ø 90.**

Control station with mushroom head momentary Ø 90.

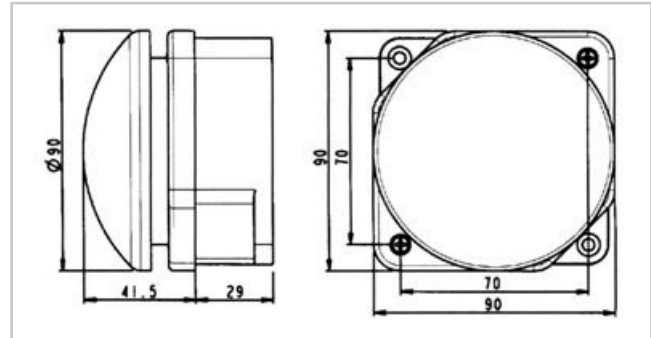

**Contatto/Contact** (PF. 10)

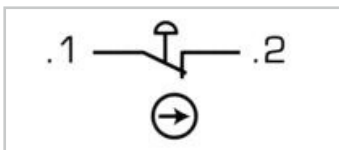

**Contatto/Contact** (PF. 20)

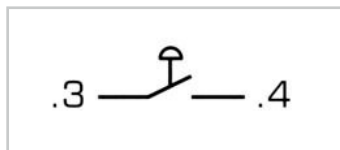

Articolo Art.	Modello Model
PF. 10	PG1M9W01
PF. 20	PG8M9W10

### CARATTERISTICHE ELETTRICHE / ELECTRICAL CHARACTERISTICS

- Grado di protezione EN60529 IP 66  
Protection degree EN60529 IP 66.
- A doppio isolamento  
Double insulated
- Capacità n°. contatti max. 3 elementi  
Number contact capacity max. 3 contact block.
- Entrata cavi n° 3 fori sfondabili Pg 13,5/M20  
Cable entry with 3 holes Pg 13,5/M20.
- Temperatura ambiente: di impiego -25° +70°C - di stoccaggio -30° +70°C  
Ambient temperature: operating -25° +70°C - storage -30° +70°C.
- Resistenza al clima: IEC 68 2-3, 2-30  
Climate protection: IEC 68 2-3, 2-30
- Identificazione morsetti: EN 50013  
Terminals referencing: EN 50013.

Tensione nominale di impiego Ue Rated operating voltage Ue	V	690
Corrente nominale termica Ithe Rated thermal current Ithe	A	10
Correnti nominali di impiego Ie - Rated operating current Ie:		
AC - 15	V/A	24/16 - 60/12 - 110/5 - 240/5 400/4 - 500/4 - 690/2
DC - 13	V/A	24/2 - 48/2 - 60/1 110/0,4 - 250/0,4
UL 508		A600 - Q600
Omologazioni Approvals		UL, IMQ, CCC, GOST-R, R.I.NA

## ELEMENTI DI CONTATTO CONNESSIONI A MOLLA

### CONTACT BLOCKS SPRING LOADED TERMINALS

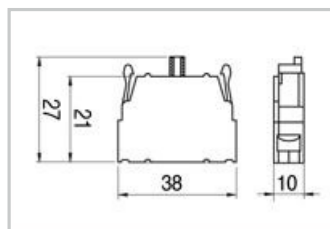

Articolo Art.	Modello Model
PL. 15	PCW01
PL. 16	PCW10

**PL. 15**

Schema/Designation

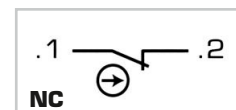

Funzioni/Function

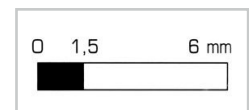

**PL. 16**

Schema/Designation

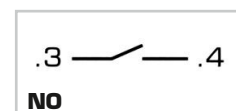

Funzioni/Function

